

# SOURIAU PA&E

## Hermetic Circular DC Connectors

- ✓ Lightweight Al shells
- ✓ MIL-DTL-38999 compliant interface
- ✓ Ceramic-to-metal sealing
- ✓ Copper alloy pens
- ✓ Harsh environment reliability
- ✓ Laser weld and jam nut configurations

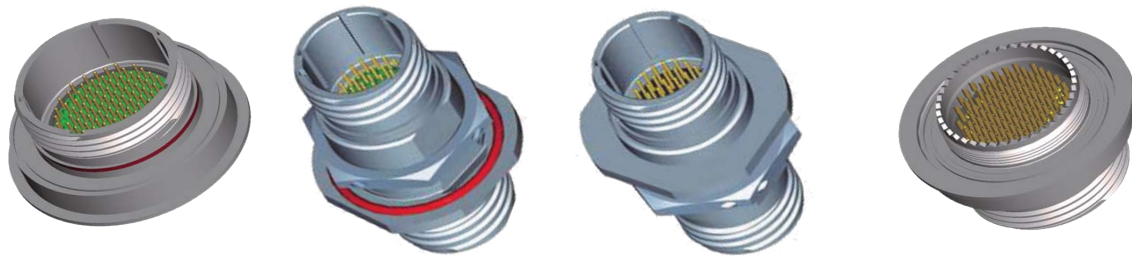

SOURIAU PA&E combines ceramic-to-metal sealing technology with light-weight materials to create reliable hermetic MIL-DTL-38999 compliant connectors that are up to 60% lighter than stainless steel versions.

		PERFORMANCE CONFIGURATION
SPECIFICATIONS	MATERIAL COMPATIBILITY	Designed for Aluminum, Titanium or Iron/Nickel Alloy Applications
	CONTACT MATERIAL	Beryllium Copper CDA Alloy 172/173
	SHELL FINISH OPTIONS	Passivated, Nickel/Gold Plated or Chromate Conversion Coated as Applicable
	CONTACT FINISH	Nickel/Gold Plating
	INTERFACE	Per MIL-DTL-38999
	NUMBER OF CONTACTS	Per MIL-DTL-38999
	OPTIONAL SOLDER CUP	Accepts 24 to 30 AWG Solid/Stranded Wire
PERFORMANCE	LEAK RATE	Less Than <b>1X10<sup>-9</sup></b> cc/sec Helium at 1 Atmospheric Differential Pressure
	INSULATION RESISTANCE	Provides Greater Than 5,000 Megohms at 500 VDC When Tested in IAW MIL-STD-1344, Method 3003
	DIELECTRIC WITHSTANDING VOLTAGE	Exhibit no Evidence of Breakdown or Flashover When Tested in IAW MIL-STD-1344, Method 3003
	CORROSION	Connectors Meet Salt Spray Test in IAW MIL-STD-1344, Method 3003
	OPERATING TEMPERATURE	-65°C to 200°C

## SOURIAU PA&E

434 Olds Station Road Wenatchee, Washington 98801  
 TEL 509.664.8000 FAX 509.663.5039  
[www.pacaero.com](http://www.pacaero.com)



ISO 9001:2008/  
AS9100

