

NOTES:

1. HOLES AND INTERFACE DIMENSIONS PER MIL-PRF-83513/2.
2. MATEABLE WITH CONNECTORS MANUFACTURED PER MIL-PRF-83513/1 AND MIL-PRF-83513/3.
3. DESIGNED TO BE LASER WELDED TO AN ALUMINUM HOUSING.
4. HERMETIC LEAK RATE: LESS THAN OR EQUAL TO  $1 \times 10^{-9}$  CC/SEC  $H_2$  AT 1 ATM DIFFERENTIAL PRESSURE.
5. ELECTRICAL REQUIREMENTS:
  - INSULATION RESISTANCE: GREATER THAN 5,000 MEGOHMS AT  $500 \pm 10\%$  VDC AT  $25^\circ C$  WHEN TESTED IAW MIL-STD-1344, METHOD 3003.
  - DIELECTRIC WITHSTANDING VOLTAGE: MUST SHOW NO EVIDENCE OF BREAKDOWN OR FLASHOVER WHEN SUBJECTED TO 500 VAC RMS 60 Hz IAW MIL-STD-1344, METHOD 3001. DURATION OF APPLICATION TO BE 1 SEC MIN.
6. MATERIALS:
  - SHELL: EXPLOSION BONDED 300-SERIES STAINLESS STEEL TO 4XXX SERIES ALUMINUM.
  - CONTACTS: BERYLLIUM-COPPER IAW ASTM B196 OR ASTM B197.
  - INSULATORS: KRYOFLEX 313 PROPRIETARY POLYCRYSTALLINE CERAMIC.
  - INTERFACIAL SEAL: FLUOROSILICONE RUBBER IAW MIL-R-25988, CLASS I, TYPE II, GRADE 60.
7. FINISHES:
  - CONTACTS: ELECTROLYTIC NICKEL PLATE IAW QQ-N-290, .000050/.000150 THICK.
  - GOLD PLATE IAW ASTM-B488, TYPE III, CODE C, .000050/.000100 THICK.
8. ORDERING INFORMATION:
  - PLEASE SPECIFY ACCORDING TO THE FOLLOWING

94020 - 9

BASE PART NUMBER TO ORDER      NUMBER OF CONTACTS

TABLE I				
PART NUMBER	W	X	Z	CONTACTS
94020-9	.951	.565	.954	9
94020-15	1.101	.715	1.104	15
94020-21	1.251	.865	1.254	21
94020-25	1.351	.965	1.354	25
94020-31	1.501	1.115	1.504	31
94020-37	1.651	1.265	1.654	37

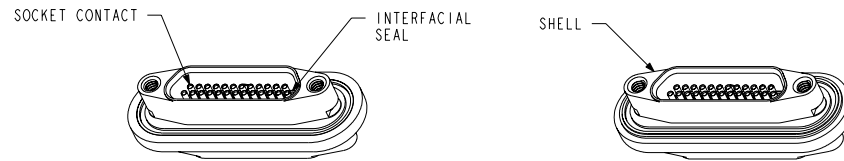
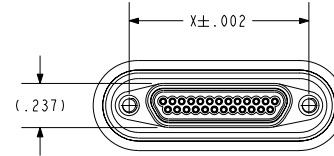
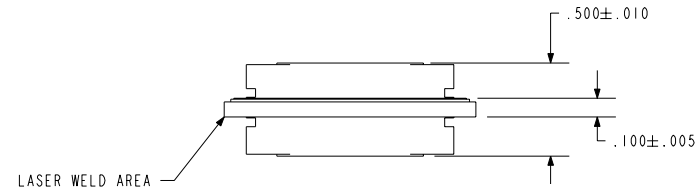
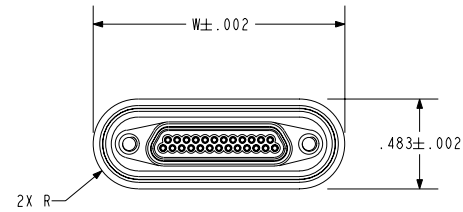

(-25 SHOWN FOR REFERENCE ONLY)

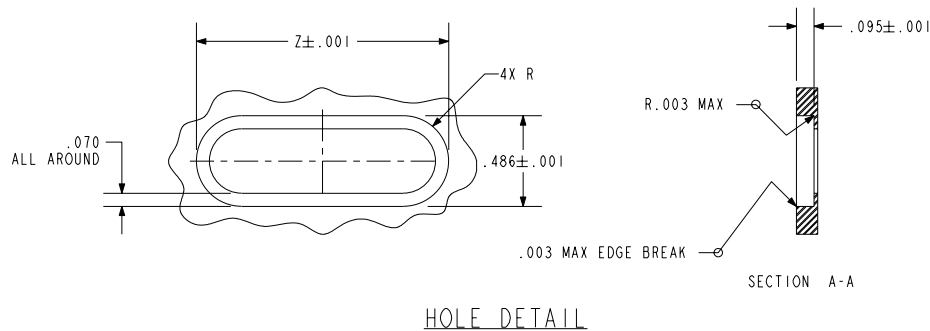

HOLE DETAIL

**PACIFIC AEROSPACE & ELECTRONICS, INC.**  
 434 Olds Station Rd. Wenatchee, Washington 98801

WWW.PACAERO.COM

THIRD ANGLE PROJECTION

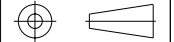

CAGE CODE: 64567

TITLE: CONNECTOR, MICRO-D, DOUBLE-ENDED, AL COMPATIBLE

VERSION: B.0

RELEASE DATE: 10-09-06

SALES DRAWING

SHEET: 1 OF 1

DOCUMENT: 0-94020